



4145

WATERPARK WONDERS TWO-TIER WATER TABLE™

The Step2 Company, LLC.

10010 Aurora-Hudson Rd.
Streetsboro, OH 44241 USA
1-800-347-8372 USA & Canada Only
(330)656-0440
www.step2.com



ENGLISH

Intended for use by children from ages 1.5 years and up.

OBSERVE THE FOLLOWING STATEMENTS AND WARNINGS TO REDUCE THE LIKELIHOOD OF SERIOUS OR FATAL INJURY.

SAVE THIS SHEET FOR FUTURE REFERENCE.

⚠️ WARNING:

CHOKING HAZARD

Small parts. Sharp points. Adult assembly required.

⚠️ WARNING:

BURN HAZARD

- Always check the temperature of the product before letting your children play on it.
- Remember that the product may cause burns.
- Always be aware of the sun and weather conditions, and do not assume that the equipment is safe because the air temperature is not very high.

INSTALLATION

- **DO NOT** install the product over concrete, asphalt, or any other hard surfaces.
- Adult supervision required.
- Instruct children not to use product until properly assembled.
- Maximum weight per seat: 50 lbs (22,68 kg). limit 1 children.
- **DO NOT** remove any screws once installed. For disassembly, only remove parts not secured by screws.
- **DO NOT** over-tighten screws or they will not hold parts together appropriately.
- Take notice that screws are designed to pierce the plastic and form their own threads.

To Empty Water:

- Empty top table first. Open drain plug and allow to drain fully. Once top section can safely be lifted, tip to empty any remaining water.
- Empty bottom table second. Open drain plug and allow to drain fully, about 1" of water will remain in base. Tip base toward open drain allowing excess water to drain. Flip completely over to remove the remaining water.
- Completely dry and store in a dry, protected area when not in use.

⚠️ WARNING:

DROWNING RISK:

- Children, especially children younger than five years, are at high risk of drowning.
- Keep children in your direct sight, stay close, and actively supervise them when they are in or near this product and when you are filling and emptying this toy of water.
- Drowning occurs silently and quickly and can occur in as little as 2 inches (5 cm) of water.
- When searching for a missing child, check the product first, even if child is thought to be in the house.
- Children can drown in very small amounts of water. Empty product completely after each use and store the empty product in such a way that it does not collect water from rain or any other source.
- Do not leave toys inside product, since toys and similar items might attract a child to the product.
- Position furniture (for example; tables, chairs) away from product so that children cannot climb on it to gain access to the product.

DIVING RISK:

- Do not dive into product. Diving into shallow water can result in a broken neck, paralysis, or death.

ELECTROCUTION:

- Keep all electrical lines, radios, speakers and other electrical appliances away from the product.
- Do not place near or under overhead electrical lines.

FIRST AID:

- Keep a working phone and a list of emergency numbers near the product.
- Become certified in cardiopulmonary resuscitation (CPR). In the event of an emergency, immediate use of CPR can make a life-saving difference.

⚠️ WARNING:

DROWNING HAZARD

Never leave your child unattended.



- Children under 5 are at highest risk of drowning.
- Closely watch children who are in or near this product.
- Empty product after use.

CLEANING INSTRUCTIONS

General Cleaning:

- Use a 50/50 mixture of white vinegar and water.
- Water should be changed frequently. Sanitize occasionally to remove organic debris and prevent bacterial growth.
- Parents should thoroughly wash accessories with mild soapy water before use.

DISPOSAL INSTRUCTIONS:

Please recycle when possible. Disposal must be in compliance with government regulations.

INSPECT THIS PRODUCT BEFORE EACH USE. TIGHTLY SECURE CONNECTIONS AND REPLACE DAMAGED OR WORN COMPONENTS. CONTACT THE STEP2 COMPANY FOR REPLACEMENT PARTS.

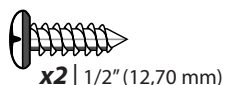
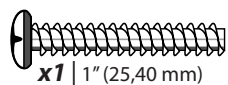
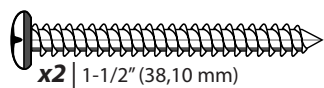
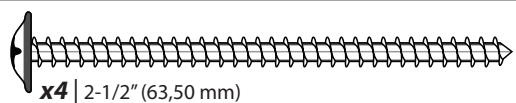
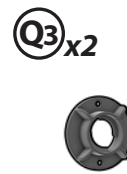
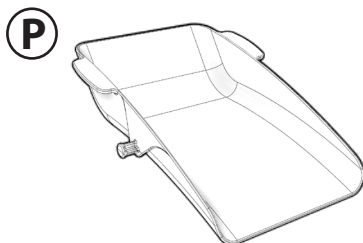
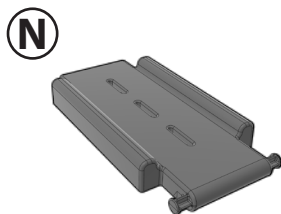
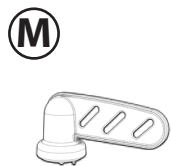
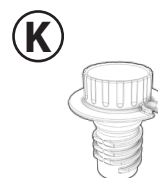
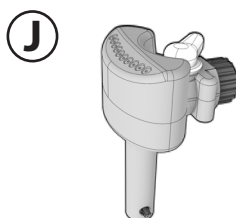
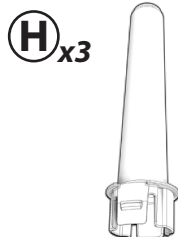
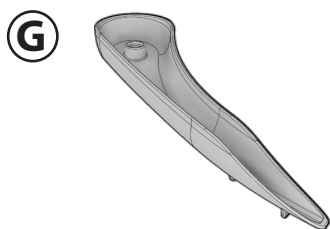
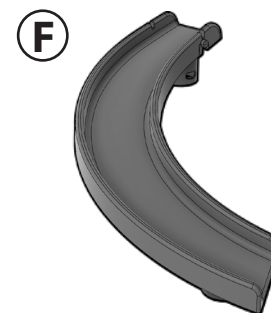
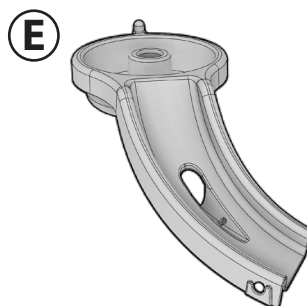
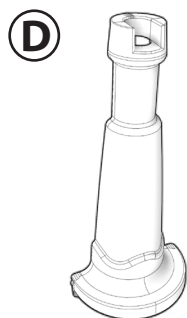
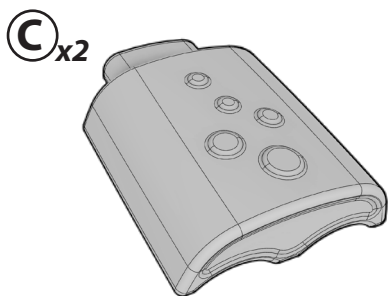
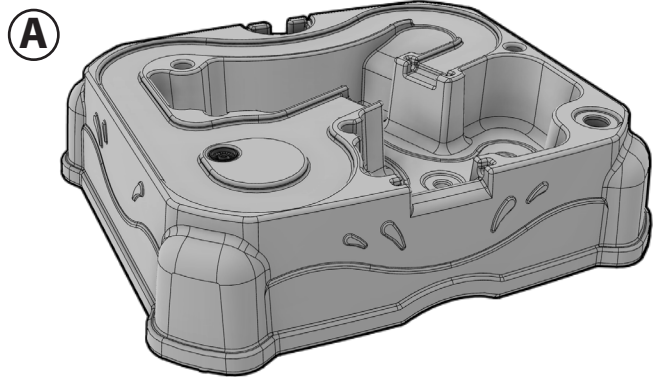

NOT INCLUDED / NON INCLUS / NO INCLUIDO / NON INCLUSO / NIET INBEGREPEN /
 NÃO INCLUSO / NIE ZAWARTY / NICHT ENTHALTEN / 不包含 / غير مشمول

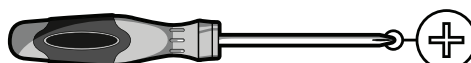

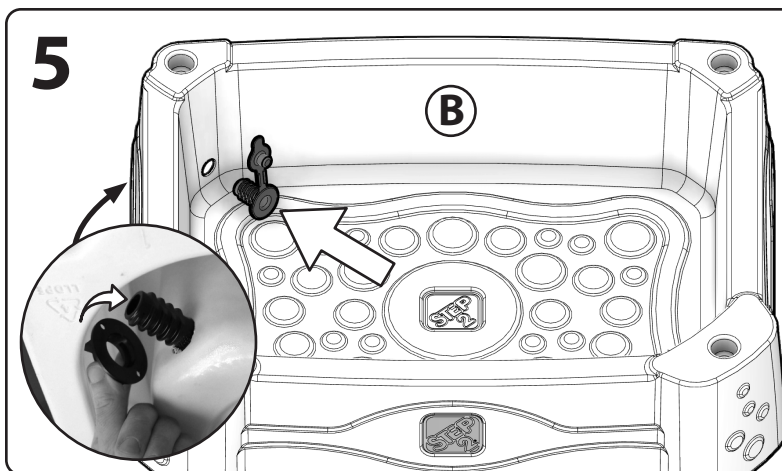
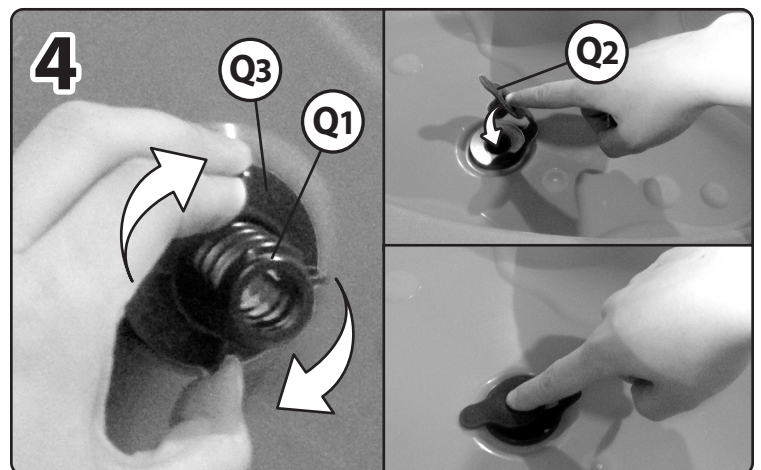
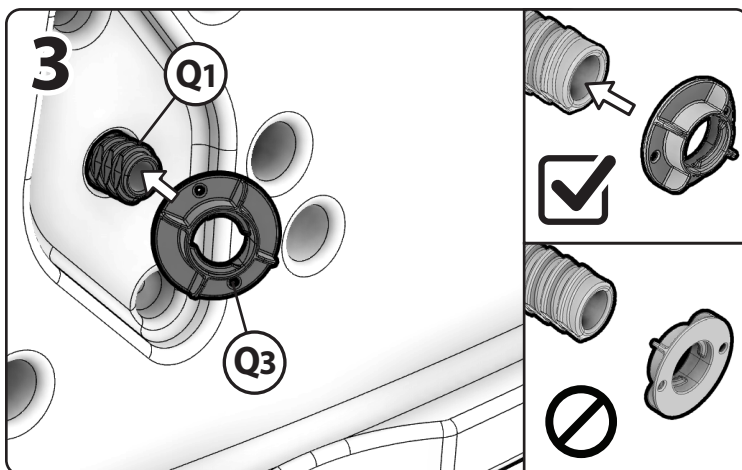
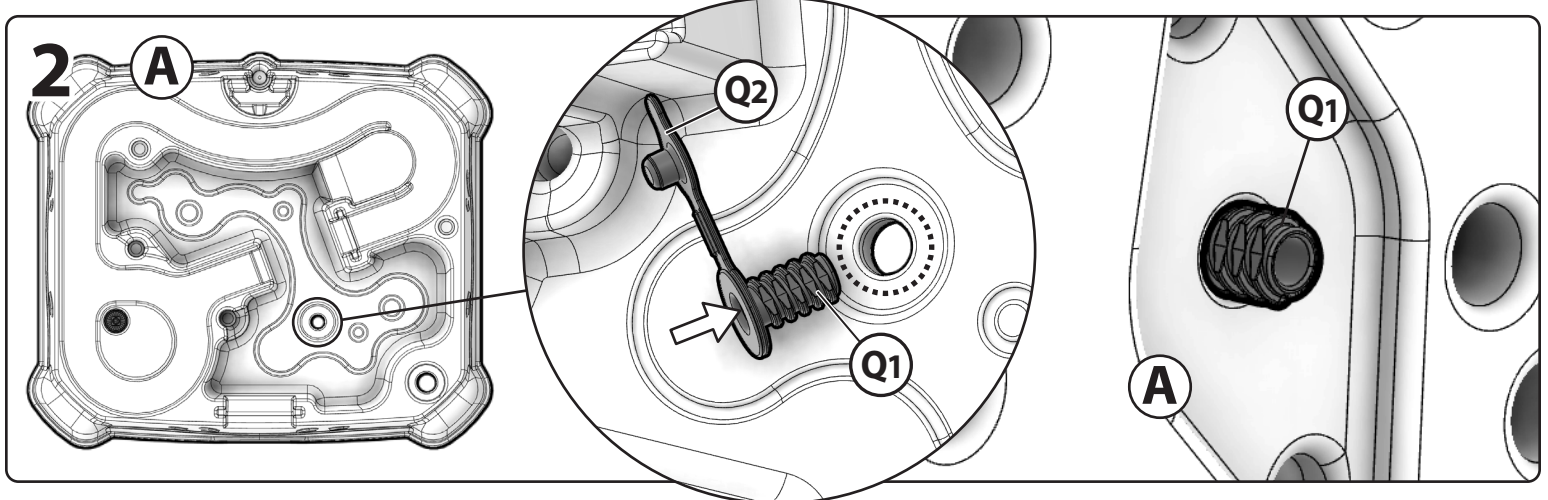
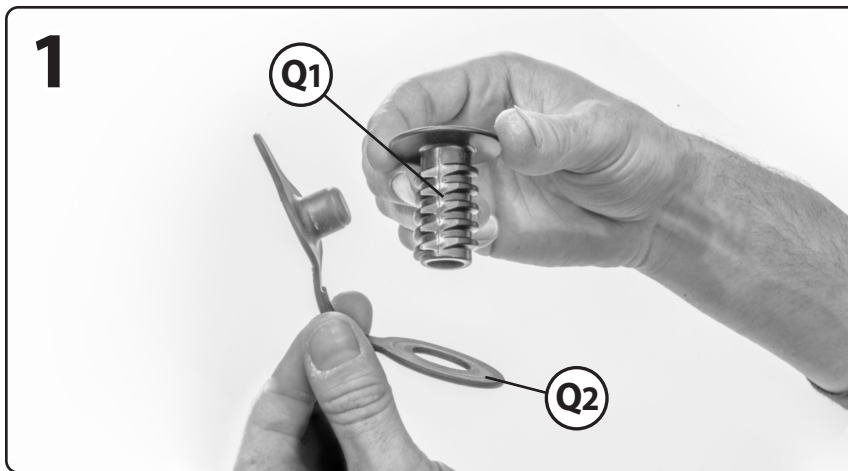

Repeat steps 1-4 to bottom table (B).
 Répétez les étapes 1 à 4 jusqu'au tableau du bas (B).
 Repita los pasos 1-4 hasta la tabla inferior (B).
 Ripetere i passaggi 1-4 fino alla tabella in basso (B).
 Herhaal stap 1-4 tot de onderste tabel (B).
 Powtórz kroki 1-4 do dolnej tabeli (B).
 Repita as etapas 1 a 4 para a tabela inferior (B).
 Wiederholen Sie die Schritte 1-4 bis zum unteren Tisch (B).
 对底部表格 (B) 重复步骤 1-4。
 كرر الخطوات من 1 إلى 4 إلى الجدول السفلي (ب).

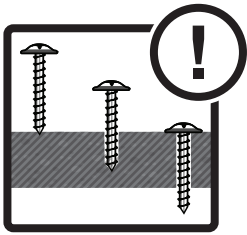

PLEASE NOTE: Product has no holes. Screws form their own. Apply pressure. Scan QR code for screw installation tips.

VEUILLEZ NOTER : Le produit n'a pas de trou. Les vis formeront leurs propres trous. Appliquez une pression. Scannez le code QR pour obtenir des conseils sur l'installation des vis.

POR FAVOR, TENGA EN CUENTA QUE: El producto no tiene orificios. Los tornillos forman sus propios orificios. Ejercer presión. Escanee el código QR para obtener consejos sobre la instalación de tornillos.

NOTA: Sul prodotto non sono presenti fori. Le viti sono autofilettanti. Premerle in posizione. Scansionare il codice QR per suggerimenti sull'installazione delle viti.

ATTENTIE: Dit product is niet voorzien van schroefgaten. De schroeven vormen hun eigen gaten. Oefen druk uit. Scan de QR-code voor tips ten aanzien van de installatie van schroeven.

TENHA EM ATENÇÃO: O produto não tem furos. Os parafusos são autorroscantes. Aplique pressão. Digitalize o código QR para obter dicas de instalação de parafusos.

UWAGA: Produkt nie zawiera otworów. Wkręty tworzą własne otwory. Należy je dociskać. Zeskanować kod QR, aby uzyskać wskazówki dotyczące montażu wkrętów.

BITTE BEACHTEN: Das Produkt hat keine Bohrungen. Die Schrauben bilden beim Eindrehen ihre eigenen Bohrungen. Wenden Sie Druck an. Scannen Sie den QR-Code für Tipps zur Schraubenmontage.

请注意：产品无孔。自攻螺钉会自己钻孔。施加压力。扫描二维码查看螺钉安装提示。

يرجى ملاحظة أنه: لا توجد ثقوب بالمنتج. تفتح المسامير الثقوب الخاصة بها. اضغط. قم بمسح كود QR لقراءة النصائح الخاصة بتركيب المسامير.



www.step2.com/video-tips

